

Rec#	_____
Date	_____
\$ Amount	_____
Rec'd By	_____

Pomperaug District Department of Health

800 Main Street South, Suite 124, Southbury, CT 06488
 (203)264-9616 - Woodbury (203)266-4785 - Oxford (203)888-6891
 Fax: (203)262-1960 - Website: www.pomperaughealthdistrict.org

Application for Building Additions, Pools, Accessory Structures

NOTE: A scaled diagram of the proposed addition or accessory structure in relation to existing structures, property lines, existing septic system and water source must be shown on attached detailed plot plan. This plot plan must show adequate area for primary septic system replacement (Code-Complying Area). Building modifications require current and revised floor plans.

Fee \$60 (Sheds without foundations \$10)

Property Address _____		
Street		Town

Owner		
Name _____	Tel # _____	Fax# _____
Address _____		
Street	Town	Zip

Contractor		
Name _____	Tel # _____	Fax# _____
Address _____		
Street	Town	Zip

Detailed Description of Request (addition/structure dimensions, # & type of rooms to be added, above or below ground pool, etc.)

Residential _____	Non-Residential _____
# of Bedrooms:	
Before Addition _____	After Addition _____
Square Footage:	
Existing dwelling _____	Addition _____
Footing Drains Required for Addition:	
Yes _____	No _____

Water Supply:
Private _____ Public _____
Septic System:
Year Installed _____
Tank Size (gal) _____
Size & Type of Leaching System: _____

NOTE: The Pomperaug Health District assumes no responsibility for the present or future operation of the septic system or for any damage to the septic system caused by the new construction or any necessary testing.

Signed _____
 (Owner or Duly Authorized Representative)

Date _____

SAMPLE PROPOSAL AND INFORMATION

Required separating distances:

From any part of existing or replacement septic system

From Well

- | | | |
|--|--------------|---------|
| • Building without footing drains - Septic Tank only..... | 10 feet..... | X |
| • Building without footing drains - .Septic System, excluding tank | 15 feet..... | X |
| • Building with full foundation & footing drain..... | 25 feet..... | 25 feet |
| • Above ground pool..... | 10 feet..... | X |
| • In-ground pool..... | 25 feet..... | 25 feet |
| • Accessory structure with foundation (no footing drains)..... | 10 feet..... | X |
| • Accessory structure without foundation..... | 5 feet..... | X |
- (note- structure without full frost protected footings)

Sample Diagram:

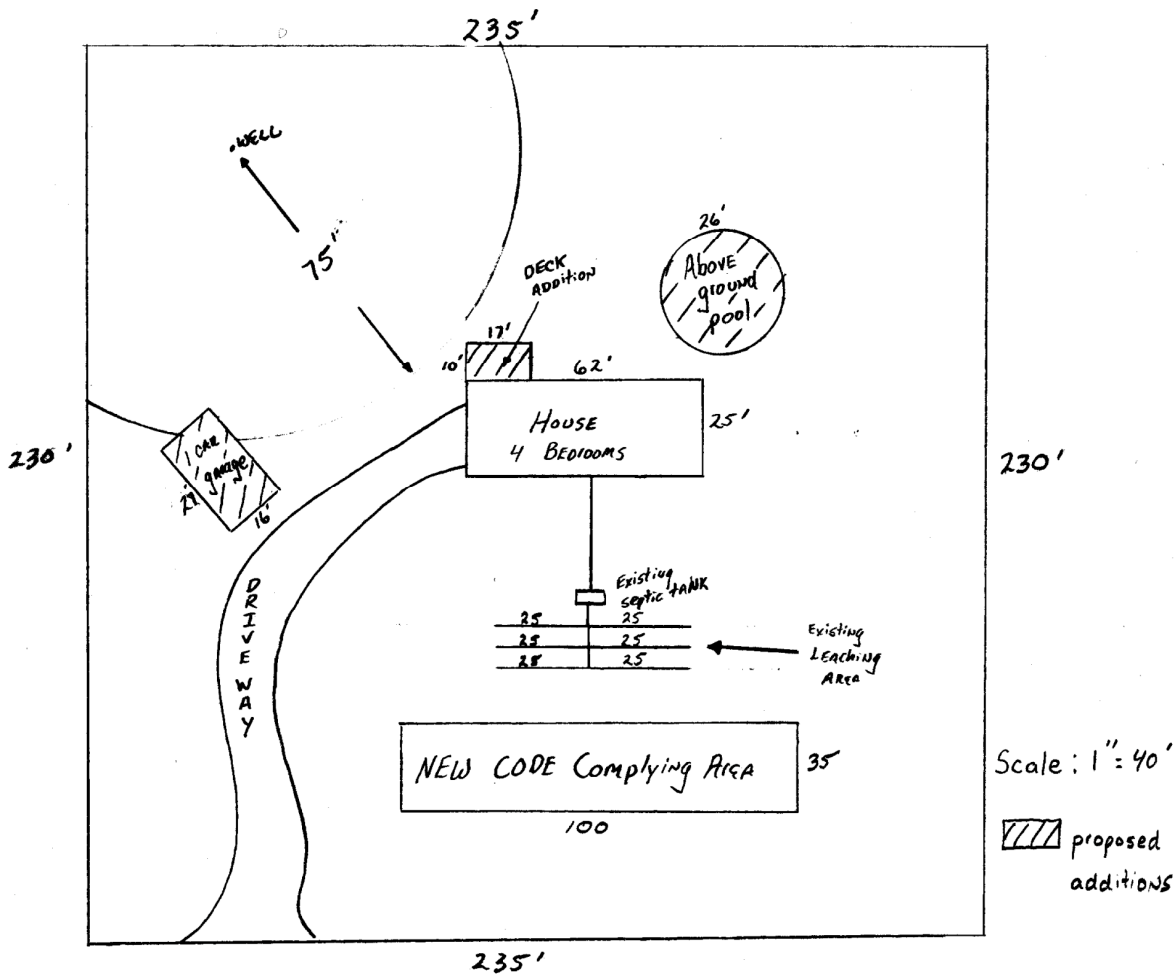

Adequacy of the Lot:

Before additions, etc. can be approved, a septic system replacement area (code-complying area) must be shown to exist on the property. Soil testing may be required.

Location:

The septic system location must be determined before work begins to ensure that the system will not be damaged during construction. Also, make sure the planned addition is not where your septic system is located or in an area that may be utilized as a septic area in the future.